

The CFM600 is designed with a maximum number of 10 parallel lanes which allow to reach a nominal production speed of 600/750 capsules/min.

The speed depends on the doser and welding cycle time, variable according to the materials (capsule and top lid film).

The machine is suitable for filling any type of capsules made by different material (even the top lid film) that can be plastic, aluminum or compostable.

The aluminium products feeding on the parallel lanes is made by capsules destacker group that prepare it for the first internal station of the machine (Entry Pick & Place).

In case the products are composed by any other materials (plastic, pbt or compostable) the feeding are made through Bowl Feeder Group.



MAIN FEATURES:

- Most compact machine dimensions ever
- Open frame for easy maintenance
- Extractable main groups for quick format change
- Capsules supports on transport belt (4 to 10 for each row) made for easy substitution for format change
- Lifting system for Capsule supports to increase centering precision under the primary groups



TECHNICAL DATA:

MACHINE SPEED: 60 RPM

PRODUCTION SPEED:

- 240 Capsules/min -> 4 Lanes
- 600 Capsules/min -> 10 Lanes

OPTIONAL GROUPS:

- Capsules "smart" weight control
- Vision System for quality control
- Caps Printer for mark each capsule
- Waste Crusher which extracts the drilled Top Lid Film spool and press the material for garbage
- Automatic Film Centering

AIR PRESSURE: 6 bar

AIR CONSUMPTION: < 1800 NI/min

POWER INTALLED: 28 Kw

SUPPLY VOLTAGE: 400Vac + N - 50Hz

MACHINE WEIGHT: 5800 Kg

MACHINE FORMAT RANGE:

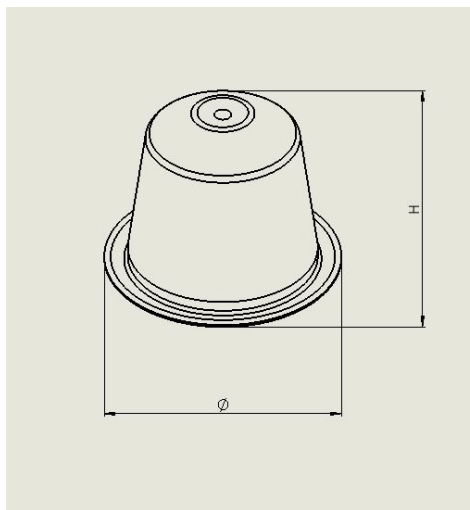

SIZE (mm)		
	Ø	H
Min	37	17
	Ø	H
Max	54	45

MACHINE LAYOUT:

